

IMPLANTACIÓN CASTILLO DE 138V

ESCALA = 1:25

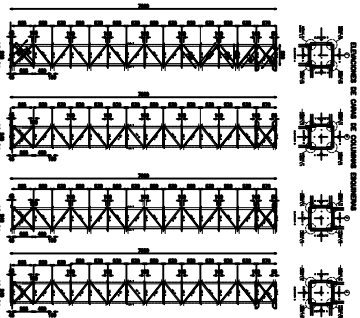

ELEVACIONES DE COLUMNAS CASTILLO DE 138V

ESCALA = 1:25

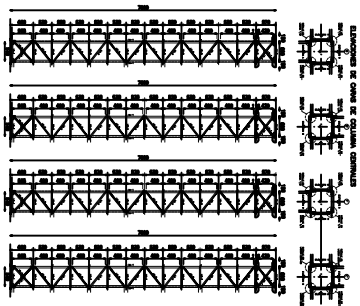

ELEVACIONES DE COLUMNAS CASTILLO DE 138V

ESCALA = 1:25

## PLANILLA DE MATERIALES

ELEMENTO	UBICACION	UNIDADES (u)	MARCA	MATERIAL	CANTIDAD (u)	LONGITUD (mm)	PESO UNITARIO (Kg/m - Kg)	PESO TOTAL (Kg)	OBSERVACION	
	Arquillos Verticales	8	LA-1	L 50x5	4	7800	3.72	515.85	Verticales	
			LA-2	L 50x4	2	980	2.93	215.89	Parantes	
			LB-1	L 70x6	1	600	6.13	28.42	Base	
			LB-1	L 40x3	2	727	1.77	20.57	Union Vigas	
			LB-2	L 40x3	12	730	1.77	123.92	Parantes	
			LB-3	L 40x3	12	600	1.77	101.86	Diagonales	
			LB-4	L 40x3	2	780	1.77	22.07	Union Vigas	
			PL-1	150x100x5	2	-	0.59	9.42	Union Vigas	
			PL-2	80x80x5	4	-	0.28	9.04	Union Vigas	
			PL-3	100x100x5	2	-	0.39	3.14	Union Diagonales	
	Cara Elev. "A"	8	PL-10	100x60x6	2	-	0.28	4.52	Soldadas a LD-1	
			Pernos	63/8	55	-	-	-	-	
			LA-2	61/2"	20	-	-	-	-	Parantes
			LB-1	L 70x6	2	578	2.93	32.78	Base	
			LB-1	L 40x3	1	600	6.83	20.43	Union Vigas	
			LB-2	L 40x3	2	722	1.77	123.92	Parantes	
			LB-3	L 40x3	12	730	1.77	101.86	Diagonales	
			LB-4	L 40x3	2	782	1.77	22.13	Union Vigas	
			PL-1	150x100x5	2	-	0.59	9.42	Union Vigas	
			PL-2	80x80x5	4	-	0.28	9.04	Union Vigas	
	Cara Elev. "B"	8	PL-3	100x100x4	1	-	0.31	2.51	Union Diagonales	
			PL-10	100x60x6	2	-	0.28	4.52	Soldadas a LD-1	
			Pernos	63/8	55	-	-	-	-	
			LA-3	L 50x4	2	-	2.93	28.16	Parantes	
			LB-1	L 70x6	1	600	6.83	32.78	Base	
			LB-1	L 40x3	2	722	1.77	20.43	Union Vigas	
			LB-2	L 40x3	12	730	1.77	123.92	Parantes	
			LB-3	L 40x3	12	600	1.77	101.86	Diagonales	
			LB-4	L 40x3	2	782	1.77	22.13	Union Vigas	
			PL-1	150x100x5	2	-	0.59	9.42	Union Vigas	
	Cara Elev. "C"	8	PL-2	80x80x5	4	-	0.28	9.04	Union Vigas	
			PL-3	100x100x4	2	-	0.31	2.51	Union Diagonales	
			PL-10	100x60x6	2	-	0.28	4.52	Soldadas a LD-1	
			Pernos	63/8	55	-	-	-	-	
			LA-3	61/2"	10	-	-	-	-	Parantes
			LB-1	L 70x6	1	600	6.83	28.16	Base	
			LB-1	L 40x3	2	722	1.77	20.43	Union Vigas	
			LB-2	L 40x3	12	730	1.77	123.92	Parantes	
			LB-3	L 40x3	12	600	1.77	101.86	Diagonales	
			LB-4	L 40x3	2	782	1.77	22.13	Union Vigas	
	Cara Elev. "D"	8	PL-1	150x100x5	2	-	0.59	9.42	Union Vigas	
			PL-2	80x80x5	4	-	0.28	9.04	Union Vigas	
			PL-3	100x100x4	2	-	0.31	2.51	Union Diagonales	
			PL-10	100x60x6	2	-	0.28	4.52	Soldadas a LD-1	
			Pernos	63/8	55	-	-	-	-	
			LA-3	61/2"	10	-	-	-	-	Parantes
			LB-1	L 70x6	1	600	6.83	32.78	Base	
			LB-1	L 40x3	2	722	1.77	20.43	Union Vigas	
			LB-2	L 40x3	12	730	1.77	123.92	Parantes	
			LB-3	L 40x3	12	600	1.77	101.86	Diagonales	
LB-4	L 40x3	2	782	1.77	22.13	Union Vigas				
	Cara Elev. "E"	8	PL-1	150x100x5	2	-	0.59	9.42	Union Vigas	
			PL-2	80x80x5	4	-	0.28	9.04	Union Vigas	
			PL-3	100x100x4	2	-	0.31	2.51	Union Diagonales	
			PL-10	100x60x6	2	-	0.28	4.52	Soldadas a LD-1	
			Pernos	63/8	55	-	-	-	-	
			LA-3	61/2"	10	-	-	-	-	Parantes
			LB-1	L 70x6	1	600	6.83	32.78	Base	
			LB-1	L 40x3	2	722	1.77	20.43	Union Vigas	
			LB-2	L 40x3	12	730	1.77	123.92	Parantes	
			LB-3	L 40x3	12	600	1.77	101.86	Diagonales	
LB-4	L 40x3	2	782	1.77	22.13	Union Vigas				
	Cera Elev. "F"	8	PL-1	150x100x5	2	-	0.59	9.42	Union Vigas	
			PL-2	80x80x5	4	-	0.28	9.04	Union Vigas	
			PL-3	100x100x4	2	-	0.31	2.51	Union Diagonales	
			PL-10	100x60x6	2	-	0.28	4.52	Soldadas a LD-1	
			Pernos	63/8	55	-	-	-	-	
			LA-3	61/2"	10	-	-	-	-	Parantes
			LB-1	L 70x6	1	600	6.83	32.78	Base	
			LB-1	L 40x3	2	722	1.77	20.43	Union Vigas	
			LB-2	L 40x3	12	730	1.77	123.92	Parantes	
			LB-3	L 40x3	12	600	1.77	101.86	Diagonales	
LB-4	L 40x3	2	782	1.77	22.13	Union Vigas				
	Cera Elev. "G"	8	PL-1	150x100x5	2	-	0.59	9.42	Union Vigas	
			PL-2	80x80x5	4	-	0.28	9.04	Union Vigas	
			PL-3	100x100x4	2	-	0.31	2.51	Union Diagonales	
			PL-10	100x60x6	2	-	0.28	4.52	Soldadas a LD-1	
			Pernos	63/8	55	-	-	-	-	
			LA-3	61/2"	10	-	-	-	-	Parantes
			LB-1	L 70x6	1	600	6.83	32.78	Base	
			LB-1	L 40x3	2	722	1.77	20.43	Union Vigas	
			LB-2	L 40x3	12	730	1.77	123.92	Parantes	
			LB-3	L 40x3	12	600	1.77	101.86	Diagonales	
LB-4	L 40x3	2	782	1.77	22.13	Union Vigas				
	Cera Elev. "H"	8	PL-1	150x100x5	2	-	0.59	9.42	Union Vigas	
			PL-2	80x80x5	4	-	0.28	9.04	Union Vigas	
			PL-3	100x100x4	2	-	0.31	2.51	Union Diagonales	
			PL-10	100x60x6	2	-	0.28	4.52	Soldadas a LD-1	
			Pernos	63/8	55	-	-	-	-	
			LA-3	61/2"	10	-	-	-	-	Parantes
			LB-1	L 70x6	1	600	6.83	32.78	Base	
			LB-1	L 40x3	2	722	1.77	20.43	Union Vigas	
			LB-2	L 40x3	12	730	1.77	123.92	Parantes	
			LB-3	L 40x3	12	600	1.77	101.86	Diagonales	
LB-4	L 40x3	2	782	1.77	22.13	Union Vigas				
	Cera Elev. "I"	8	PL-1	150x100x5	2	-	0.59	9.42	Union Vigas	
			PL-2	80x80x5	4	-	0.28	9.04	Union Vigas	
			PL-3	100x100x4	2	-	0.31	2.51	Union Diagonales	
			PL-10	100x60x6	2	-	0.28	4.52	Soldadas a LD-1	
			Pernos	63/8	55	-	-	-	-	
			LA-3	61/2"	10	-	-	-	-	Parantes
			LB-1	L 70x6	1	600	6.83	32.78	Base	
			LB-1	L 40x3	2	722	1.77	20.43	Union Vigas	
			LB-2	L 40x3	12	730	1.77	123.92	Parantes	
			LB-3	L 40x3	12	600	1.77	101.86	Diagonales	
LB-4	L 40x3	2	782	1.77	22.13	Union Vigas				
	Cera Elev. "J"	8	PL-1	150x100x5	2	-	0.59	9.42	Union Vigas	
			PL-2	80x80x5	4	-	0.28	9.04	Union Vigas	
			PL-3	100x100x4	2	-	0.31	2.51	Union Diagonales	
			PL-10	100x60x6	2	-	0.28	4.52	Soldadas a LD-1	
			Pernos	63/8	55	-	-	-	-	
			LA-3	61/2"	10	-	-	-	-	Parantes
			LB-1	L 70x6	1	600	6.83	32.78	Base	
			LB-1	L 40x3	2	722	1.77	20.43	Union Vigas	
			LB-2	L 40x3	12	730	1.77	123.92	Parantes	
			LB-3	L 40x3	12	600	1.77	101.86	Diagonales	
LB-4	L 40x3	2	782	1.77	22.13	Union Vigas				
	Cera Elev. "K"	8	PL-1	150x100x5	2	-	0.59	9.42	Union Vigas	
			PL-2	80x80x5	4	-	0.28	9.04	Union Vigas	
			PL-3	100x100x4	2	-	0.31	2.51	Union Diagonales	
			PL-10	100x60x6	2	-	0.28	4.52	Soldadas a LD-1	
			Pernos	63/8	55	-	-	-	-	
			LA-3	61/2"	10	-	-	-	-	Parantes
			LB-1	L 70x6	1	600	6.83	32.78	Base	
			LB-1	L 40x3	2	722	1.77	20.43	Union Vigas	
			LB-2	L 40x3	12	730	1.77	123.92	Parantes	
			LB-3	L 40x3	12	600	1.77	101.86	Diagonales	
LB-4	L 40x3	2	782	1.77	22.13	Union Vigas				
	Cera Elev. "L"	8	PL-1	150x100x5	2	-	0.59	9.42	Union Vigas	
			PL-2	80x80x5	4	-	0.28	9.04	Union Vigas	
			PL-3	100x100x4	2	-	0.31	2.51	Union Diagonales	
			PL-10	100x60x6	2	-	0.28	4.52	Soldadas a LD-1	
			Pernos	63/8	55	-	-	-	-	
			LA-3	61/2"	10	-	-	-	-	Parantes
			LB-1	L 70x6	1	600	6.83	32.78	Base	
			LB-1	L 40x3	2	722	1.77	20.43	Union Vigas	
			LB-2	L 40x3	12	730	1.77	123.92	Parantes	
			LB-3	L 40x3	12	600	1.77	101.86	Diagonales	
LB-4	L 40x3	2	782	1.77	22.13	Union Vigas				
	Cera Elev. "M"	8	PL-1	150x100x5	2	-	0.59	9.42	Union Vigas	
			PL-2	80x80x5	4	-	0.28	9.04	Union Vigas	
			PL-3	100x100x4	2	-	0.31	2.51	Union Diagonales	
			PL-10	100x60x6	2	-	0.28	4.52	Soldadas a LD-1	
			Pernos	63/8	55	-	-	-	-	
			LA-3	61/2"	10	-	-	-	-	Parantes
			LB-1	L 70x6	1	600	6.83	32.78	Base	
			LB-1	L 40x3	2	722	1.77	20.43	Union Vigas	
			LB-2	L 40x3	12	730	1.77	123.92	Parantes	
			LB-3	L 40x3	12	600	1.77	101.86	Diagonales	
LB-4	L 40x3	2	782	1.77	22.13	Union Vigas				
	Cera Elev. "N"	8	PL-1	150x100x5	2	-	0.59	9.42	Union Vigas	
			PL-2	80x80x5	4	-	0.28	9.04	Union Vigas	
			PL-3	100x100x4	2	-	0.31	2.51	Union Diagonales	
			PL-10	100x60x6	2	-	0.28	4.52	Soldadas a LD-1	
			Pernos	63/8	55	-	-	-	-	
			LA-3	61/2"	10	-	-	-	-	Parantes
			LB-1	L 70x6	1	600	6.83	32.78	Base	
			LB-1	L 40x3	2	722	1.77	20.43	Union Vigas	
			LB-2	L 40x3	12	730	1.77	123.92	Parantes	
			LB-3	L 40x3	12	600	1.77	101.86	Diagonales	
LB-4	L 40x3	2	782	1.77	22.13	Union Vigas				
	Cera Elev. "O"	8	PL-1	150x100x5	2	-	0.59	9.42	Union Vigas	
			PL-2	80x80x5	4	-	0.28	9.04	Union Vigas	
			PL-3	100x100x4	2	-	0.31	2.51	Union Diagonales	
			PL-10	100x60x6	2	-	0.28	4.52	Soldadas a LD-1	
			Pernos	63/8	55	-	-	-	-	
			LA-3	61/2"	10	-	-	-	-	Parantes
			LB-1	L 70x6	1	600	6.83	32.78	Base	
			LB-1	L 40x3	2	722	1.77	20.43	Union Vigas	
			LB-2	L 40x3	12	730	1.77	123.92	Parantes	
			LB-3	L 40x3	12	600	1.77	101.86	Diagonales	
LB-4	L 40x3	2	782	1.77	22.13	Union Vigas				
	Cera Elev. "P"	8	PL-1	150x100x5	2	-	0.59	9.42	Union Vigas	
			PL-2	80x80x5	4	-	0.28	9.04	Union Vigas	
			PL-3	100x100x4	2	-	0.31	2.51	Union Diagonales	
			PL-10	100x60x6	2	-	0.28	4.52	Soldadas a LD-1	
			Pernos	63/8	55	-	-	-	-	
			LA-3	61/2"	10	-	-	-	-	Parantes
			LB-1	L 70x6	1	600	6.83	32.78	Base	
			LB-1	L 40x3	2	722	1.77	20.43	Union Vigas	
			LB-2	L 40x3	12	730	1.77	123.92	Parantes	
			LB-3	L 40x3	12	600	1.77	101.86	Diagonales	
LB-4	L 40x3	2	782	1.77	22.13	Union Vigas				
	Cera Elev. "Q"	8	PL-1	150x100x5	2	-	0.59	9.42	Union Vigas	
			PL-2	80x80x5	4	-	0.28	9.04	Union Vigas	
			PL-3	100x100x4	2	-	0.31	2.51	Union Diagonales	
			PL-10	100x60x6	2	-	0.28	4.52	Soldadas a LD-1	
			Pernos	63/8	55	-	-	-	-	
			LA-3	61/2"	10	-	-	-	-	Parantes
			LB-1	L 70x6	1	600	6.83	32.78	Base	
			LB-1	L 40x3	2					

Σ =

23318